

MZ-G SERIES CAM CLUTCH

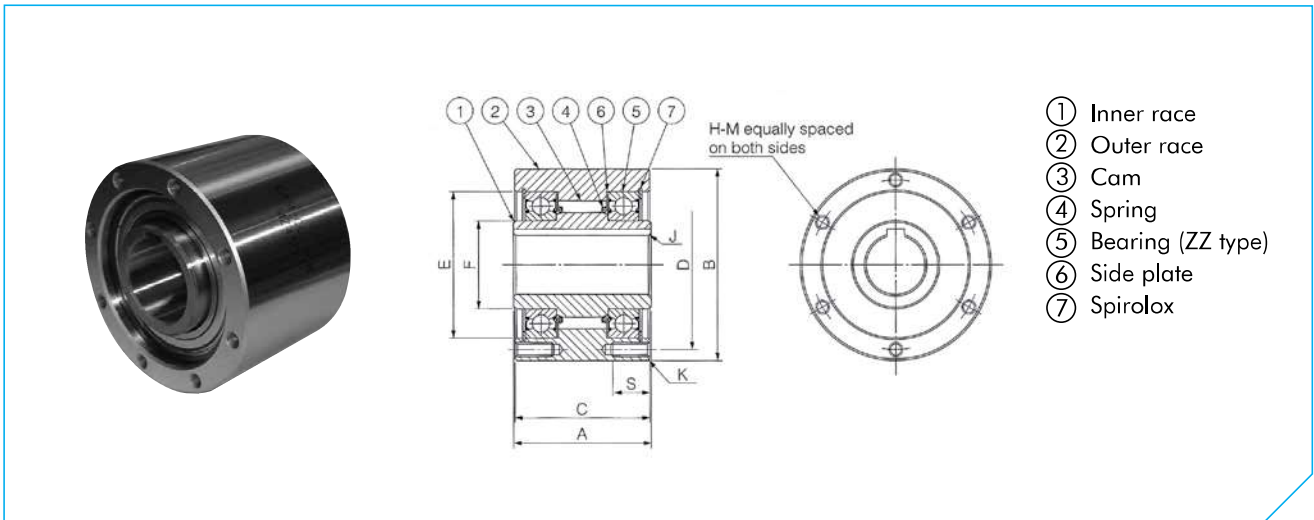

MZ-G

Dimensions in mm

Model	Bore size H7	Inner Race Keyway	J	Inner Race Width A	Outer Race Width C	B h7	F	E	K	D	S	H-M No. of Tapped Holes x Size x Pitch	Approx. Mass
													kg/pc
MZ15G*	15	5 x 2.3	0.8	55	53	68	25	47	1.3	58	10	6 x M5 x P0.8	1.3
MZ17G*	17	5 x 2.3	0.8	63	61	75	28	52	1.3	64	10	6 x M5 x P0.8	1.7
MZ20G*	20	5 x 2.3	0.8	64	62	80	30	55	1.3	68	12	6 x M6 x P1.0	1.9
MZ30G-22	22	8 x 3.3	1.0	70	68	100	45	75	1.3	88	16	6 x M8 x P1.25	3.2
MZ30G-25*	25	8 x 3.3	1.0										
MZ30G	30	10 x 3.3	1.0	78	76	110	50	80	1.3	95	16	6 x M8 x P1.25	4.4
MZ35G	35	10 x 3.3	1.0										
MZ45G-40*	40	12 x 3.3	1.3	87	85	125	60	95	1.3	110	16	8 x M8 x P1.25	6.2
MZ45G*	45	12 x 3.3	1.3										
MZ60G-50*	50	14 x 3.8	1.5	90	88	155	80	125	1.3	140	16	8 x M8 x P1.25	9.5
MZ60G-55*	55	16 x 4.3	1.5										
MZ60G*	60	18 x 4.4	1.5	105	103	175	95	145	1.3	162	16	8 x M8 x P1.25	13.1
MZ70G-65*	65	18 x 4.4	1.8										
MZ70G*	70	20 x 4.9	1.8										

* = Non-stock item

Capacities

Model	Torque Capacity Nm	Max. Overrunning Speed		Max. Indexing cycle/min	Drag Torque Nm
		Inner Race r/min	Outer Race r/min		
MZ15G*	186	1800	900	150	0.20
MZ17G*	215	1700	800	150	0.20
MZ20G*	323	1600	700	150	0.29
MZ30G-22	735	1500	500	150	0.39
MZ30G-25*					
MZ30G	1080	1400	300	150	0.49
MZ35G					
MZ45G-40*	1620	1400	300	150	0.69
MZ45G*					
MZ60G-50*	2110	1200	250	150	0.98
MZ60G-55*					
MZ60G*	3040	1100	250	150	1.27
MZ70G-65*					
MZ70G*					

* = Non-stock item

Installation and Usage

1. When mounting sprockets or gears to the outer race, use the outer race outer dimension (dimension B) to make a centering flange in the gear or sprocket. Then attach firmly with bolts of tensile strength 10.9 or greater to the tapped holes in the outer race.
2. Please refer to MZ Series for usage and other types of installations.

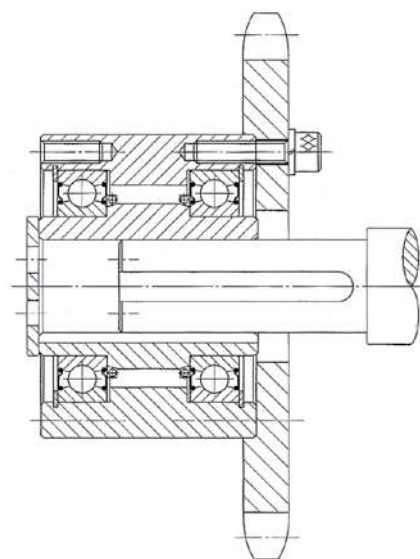

Installation example